



# TankSafe™

## Fitting Instructions



[WWW.RONTOM.CO.UK](http://WWW.RONTOM.CO.UK)

[info@rontom.co.uk](mailto:info@rontom.co.uk)

### **Rontom Automotive Limited**

Building 67, Europa Business Park, Bird Hall Lane, Cheadle Heath, Stockport, Cheshire, SK3 0XA  
Gt. Manchester, United Kingdom

Tel: +44 (0) 161 639 0200 E: [info@rontom.co.uk](mailto:info@rontom.co.uk) W: [www.rontom.co.uk](http://www.rontom.co.uk)

Vat Reg No: GB 220 3723 54 EORI No: GB220372354000

# PERMANENT FITTING INSTRUCTIONS (RECOMMENDED)

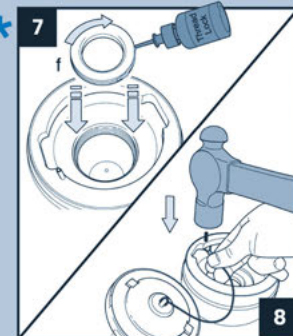
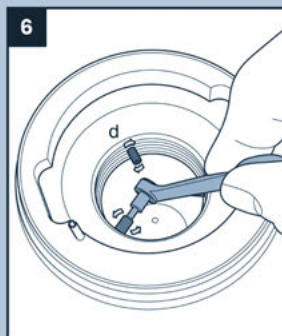
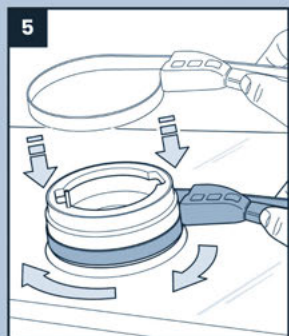
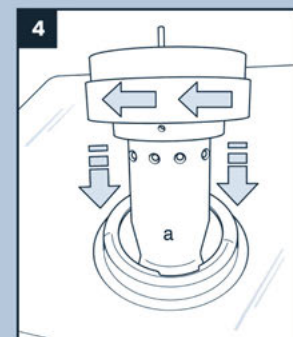
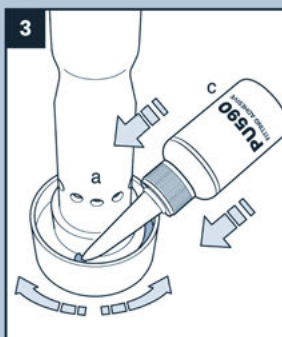
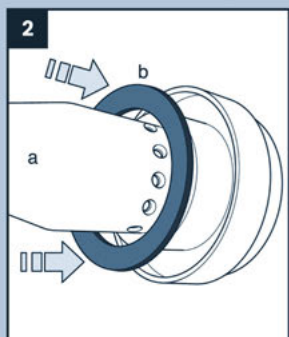

★ If the optional ASM (e) is included in your kit:

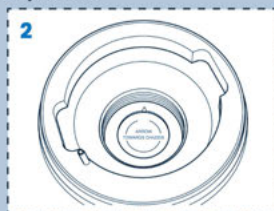
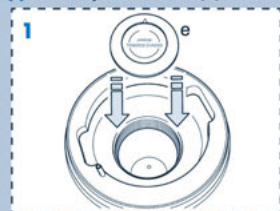

## Fitting an Anti-Spill Mechanism (ASM) if required (TIS37)

Insert the ASM into the TankSafe® neck with the arrow facing inwards towards the chassis.

Instructions are printed on the ASM.

Once fitted, revert to **step 7** of the fitting instructions.

# TRANSFERABLE FITTING INSTRUCTIONS

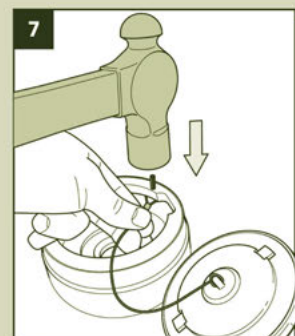
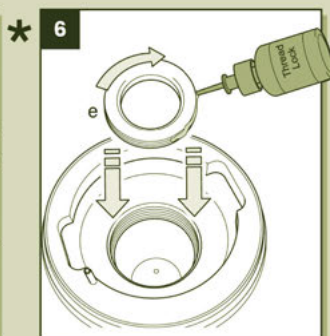
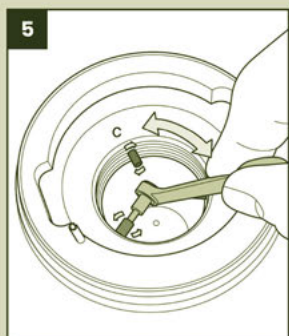
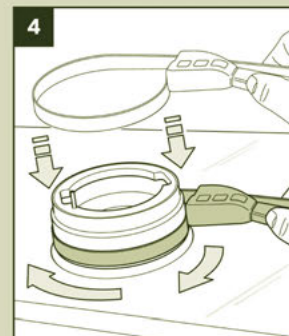
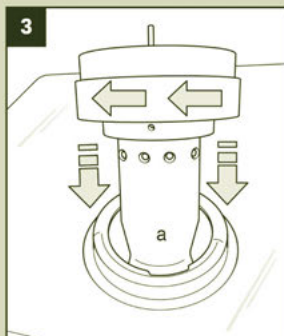
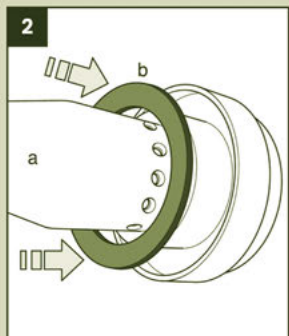

★ If the optional ASM (d) is included in your kit:

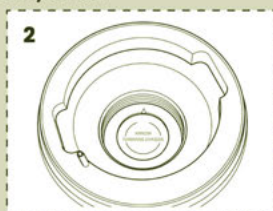
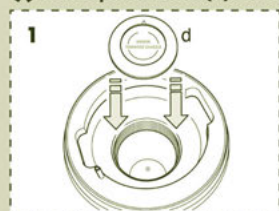

## Fitting an Anti-Spill Mechanism (ASM) if required (TIS37)

Insert the ASM into the TankSafe® neck with the arrow facing inwards towards the chassis.

Instructions are printed on the ASM.

Once fitted, revert to **step 6** of the fitting instructions.



Copyright @ 2023 Rontom Automotive Limited & Rontom ZENOX® Group.  
All Rights Reserved